



# B-CON

## HI-RES BLUETOOTH RECEIVER



POWER SUPPLY	
Voltage:	6 ÷ 24 VDC
Idling current:	70 mA @ 12 V
Remote IN voltage:	3 ÷ 12 VDC (0.5 mA)
+ 12 Remote IN voltage:	6 ÷ 12 VDC (70 mA)
USB Micro	5 V (500 mA)
BLUETOOTH	
Type:	Bluetooth 5.0 + EDR
Codec:	LDAC, AAC, SBC
Profile:	Bluetooth A2DP 1.3, AVRCP 1.6
INPUT	
Optical digital:	S/PDIF Optical (Max 24 bit/192 kHz)
INPUT/ OUTPUT MANAGEMENT	
Digital IN delay switch:	1 sec.
Power Connector:	AUX SEL wire, MASTER ENABLE wire
ADC:	Serial RS232, to manage other Audison devices that support this standard
Mode Switch:	Absolute volume ON/OFF, upgrade mode
OUTPUT	
Optical digital:	From Optical input: 24 bit 192 kHz From Streaming Bluetooth: 24 bit/96 kHz max Bandwith (MAX) 20 ÷ 48k Hz
Analog:	Output Level 2 VRMS Distortion - THD @1 kHz, 1 VRMS 0.003% S/N RATIO (A weighted) 100 dBA
SIZE	
W x H x D mm / In.	90 x 60,4 x 23 / 3.54 x 2.38 x 0.91
Weight kg / lbs:	0,054 / 0.119

The **Audison B-CON** is the only Bluetooth® 5.0 player designed for automotive use that has obtained the **"Hi-Res audio wireless"** certification from JAS (Japan Audio Society). B-CON is the ideal choice for streaming audio from a Hi-Res player (FIIO, Sony Walkman...) and from latest generation Android/Apple mobile devices.

**B-CON** is compatible with all audio formats and reaches maximum performance with uncompressed BT streaming (max 96kHz / 24bit, only with Android LDAC devices), both playing local files and with Apps that provide Hi-Res streaming (Tidal, Qobuz...)

In keeping with Audison tradition, during the design phase particular **attention was paid to volume management**, a fundamental aspect for the search for the **highest audio quality**. The study by the Audison R&D team focused on the audiophile use of the **"Absolute Volume" function**. In the **B-CON** this manages the **Master Volume of the DSP\***, **avoiding the loss of resolution** that occurs when operating on the volume of the mobile device (mode: Absolute Volume Off), **ensuring full dynamic range**.

In the case of a voice call, the DSP automatically switches to the processor's Master input \* (by associating the mobile device with the B-CON and the car). At the end of the call it reverts back to playing the song previously paused, managing the **car speakerphone without limitations**.

**Audison B-CON** has a **"pass-through" digital optical input** (max 192kHz / 24bit) which provides a second auxiliary input to the active DSP when there is no BT streaming.

The digital output (max 96kHz / 24bit) and the analog output (max 2 VRMS, S/N RATIO 100 dBA) allow the user to connect the B-CON to any audio device.

\*available on the new Forza line or on the bit One HD Virtuoso by connecting the ADC port

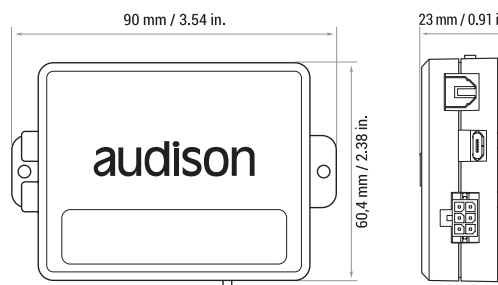

**Elettromedia**  
62018 Potenza Picena (MC) Italy  
T +39 0733 870 870 - F +39 0733 870 880  
elettromedia.com





# B-CON

## HI-RES BLUETOOTH RECEIVER

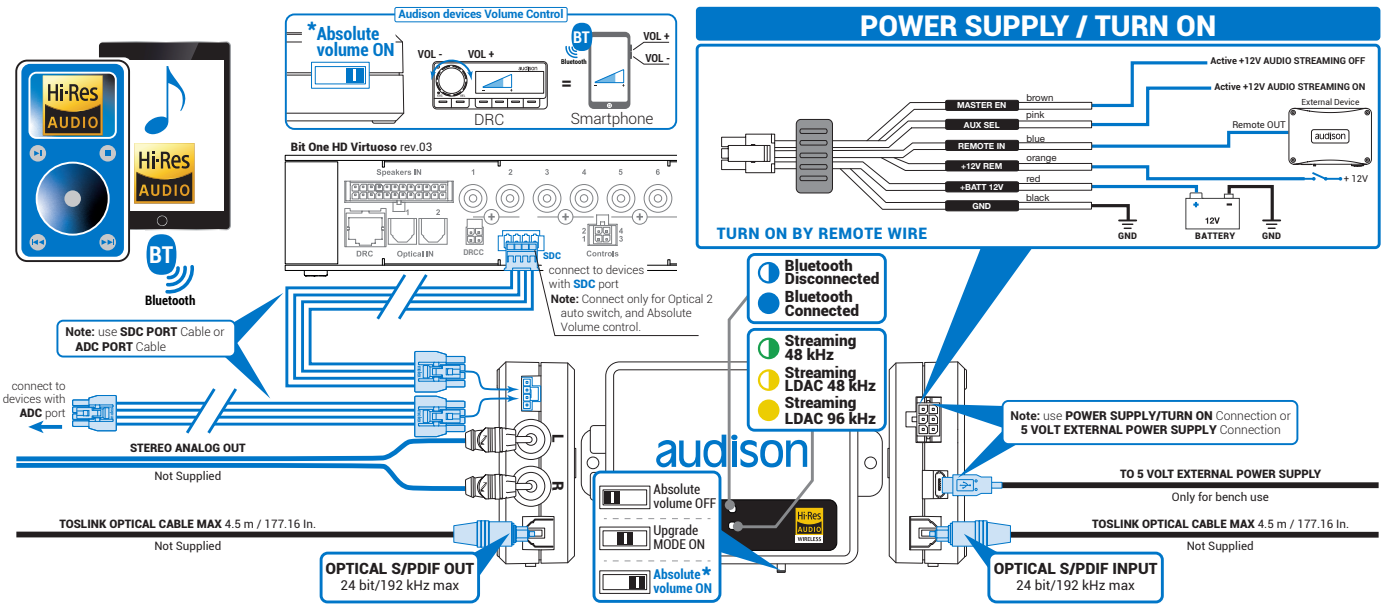

### OUTPUTS PRIORITY

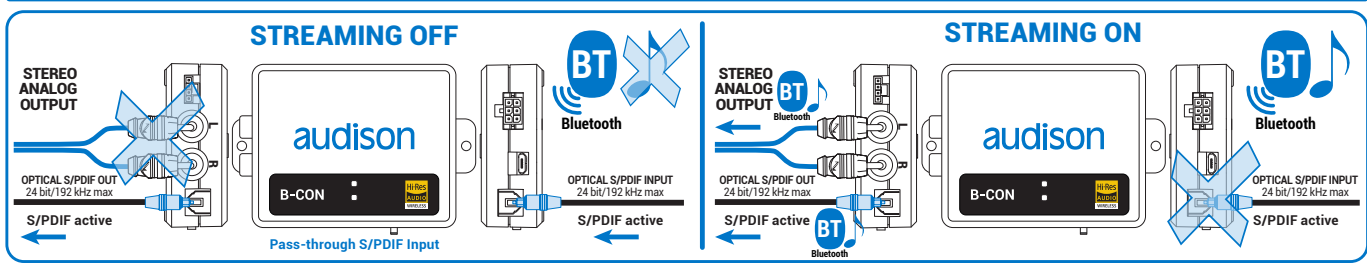

All specifications subject to change without notice\_22.A